

1500Vdc Square Body Fuse

HMSB15 Series

Fast Acting Fuse



Features

- Fast Acting fuse for Li Battery Protection
- 1500Vdc ideal for Li Battery Protection
- Excellent DC performance
- Comply RoHS directive

Specifications

Part Number	Rated Current (A)	Rated Voltage (Vdc)	Breaking Capacity (A)	i^2t (A ² S)		Power Loss At 0.5I _n (W)
				Pre-arc	Total @1000Vdc	
HMSB15-200A-TA	200	1500	50000	13480	54200	59
HMSB15-250A-TA	250	1500	50000	23000	93100	70
HMSB15-300A-TA	300	1500	50000	35600	143000	85
HMSB15-315A-TA	315	1500	50000	41500	168000	89

Temperature Rise: <50K with 50% of rated current.

Dimension (mm)

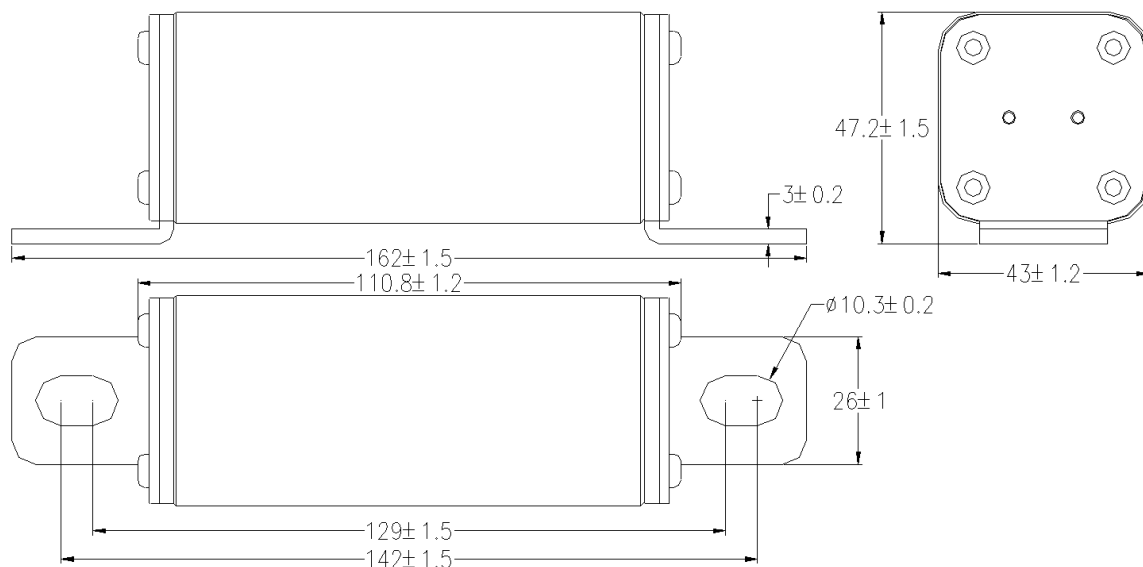

Note: 20±1Nm (M10)

1500Vdc Square Body Fuse

Fast Acting Fuse

HMSB15 Series

Temperature Re-Rating Curve

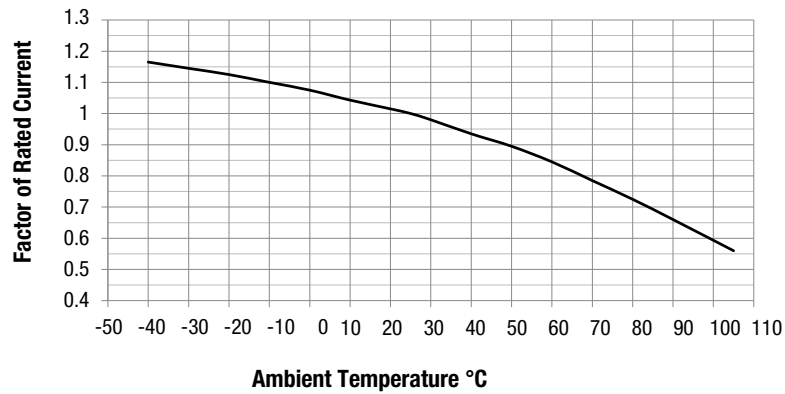

Operating Temperature: -40°C to +100°C, with proper derating factor applied.

Time-Current Curve

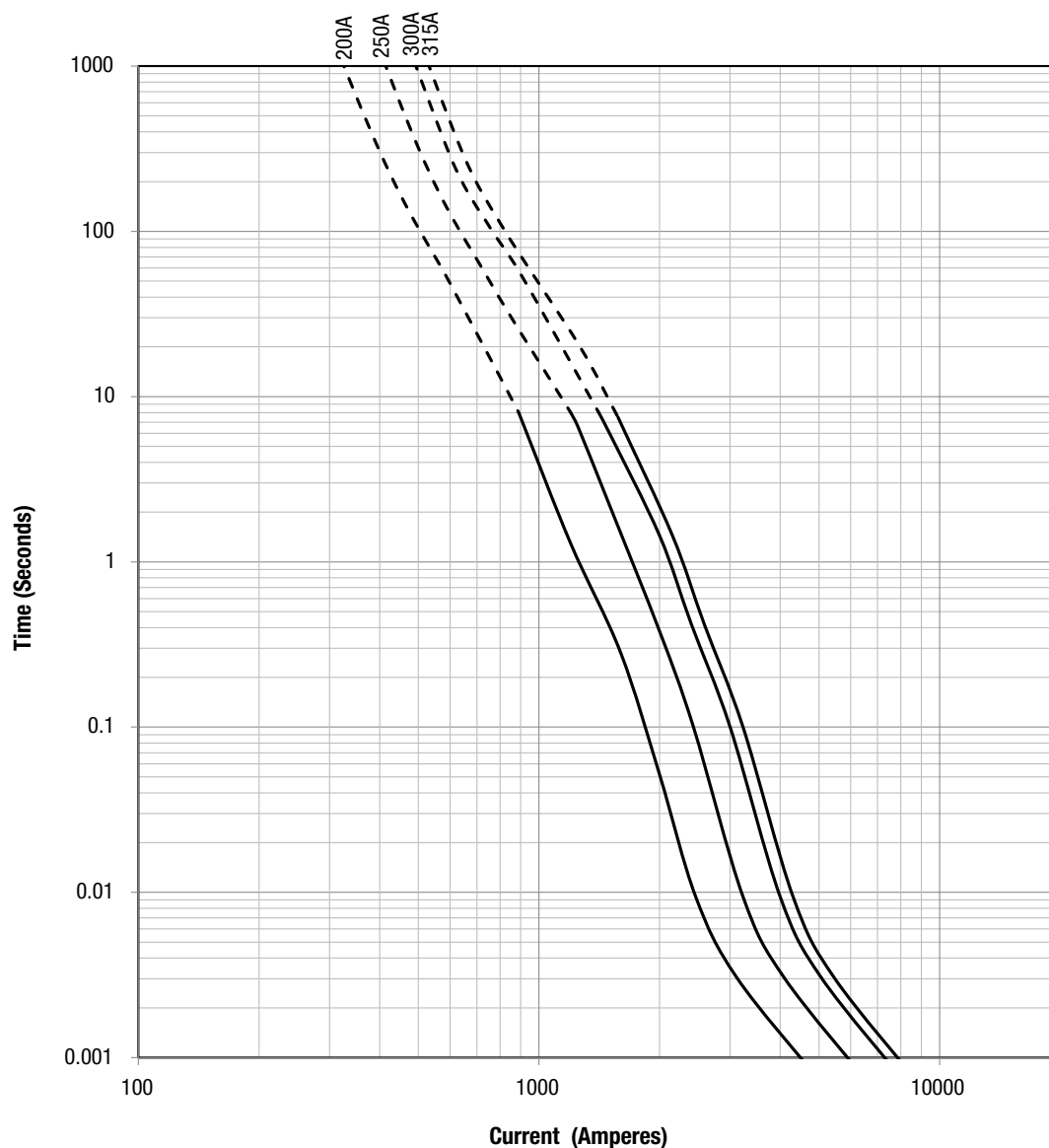

1500Vdc Square Body Fuse

Fast Acting Fuse

HMSB15 Series

Transportation and Storage

During transportation and storage, should avoid water seepage and mechanical damage.

Conditions for operation in service

Where the following conditions apply, fuses complying with this standard are deemed capable of operating satisfactorily without further qualification;

Normal temperature: -5°C to 40°C ;

The altitude of the site of installation of the fuses does not exceed 2 000 m above sea level;

The air is clean and its relative humidity does not exceed 50 % at the maximum temperature of 40°C ;

Higher relative humidities are permitted at lower temperatures, e.g. 90 % at 20°C ;

Under these conditions, moderate condensation may occasionally occur due to variation in temperature.

For operation condition other than above, please contact manufacturer.